

TANDEM plus 562F concealed drawer runners

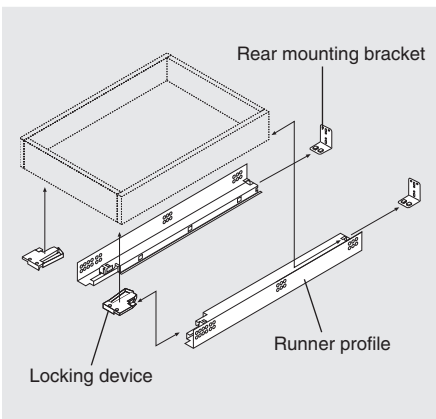

Full extension runner system

- Zinc coated steel profiles.
- Concealed roller carriage mechanism with permanently lubricated, synthetic rollers.
- BLUMATIC spring loaded self-closing action.
- Locking devices provide automatic latching, easy release for drawer removal and tool free height adjustment.
- Force guided right side and +/- 1/16" tolerance compensating left side.
- **34 kg (75 lb.)** Dynamic, and **45 kg (100 lb.)** Static weight capacities.



Overlay applications

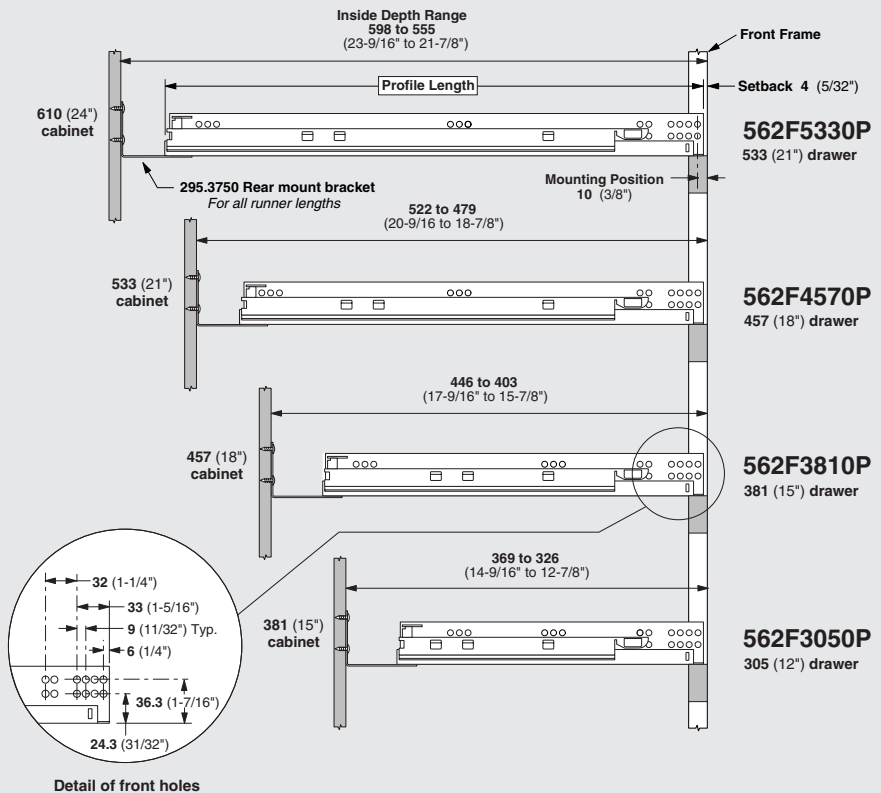

Inset applications

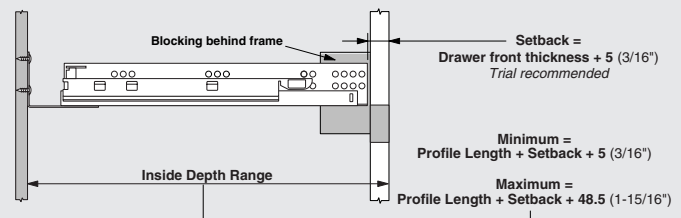

Runner Part No.	Cabinet Depth	Inside Depth		Drawer Length	Drawer Thk.	Extension Loss	Profile Length
		Maximum	Minimum				
562F5330P	610 (24")	598 (23-9/16")	555 (21-7/8")	533 (21")	19 (3/4") max.	0	546 (21-1/2")
562F4570P	533 (21")	522 (20-9/16")	479 (18-7/8")	457 (18")		0	470 (18-1/2")
562F3810P	457 (18")	446 (17-9/16")	403 (15-7/8")	381 (15")		-6 (-1/4")	394 (15-1/2")
562F3050P	381 (15")	369 (14-9/16")	326 (12-7/8")	305 (12")		-16 (-5/8")	317 (12-1/2")

Special 7/8 extension

552F2290N	305 (12")	293 (11-9/16")	250 (9-7/8")	229 (9")	19 (3/4")	36.7 (1-7/16")	241 (9-1/2")
-----------	-----------	----------------	--------------	----------	-----------	----------------	--------------

See mounting specifications on pg. 29

Installation components

T51.1700.04R	Locking device (right)
T51.1700.04L	Locking device (left)
295.3750	Rear mounting bracket - non handed

612TH	#6 x 1/2" Truss head screw
707N	#7 x 5/8" Flat head screw
295.4000	Universal Bracket kit

TANDEM plus 562F specifications

Cabinet	Frame
Extension	Full
Max. drawer thk.	19mm (3/4")
Dynamic load capacity	34 kg (75 lb.)
Static load capacity	45 kg (100 lb.)

Drawer and cabinet specifications

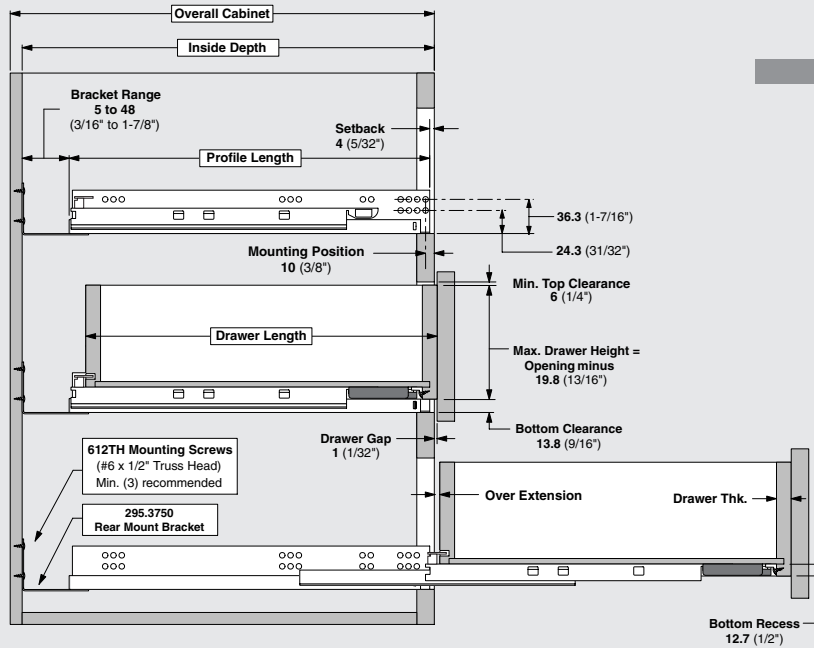

Preparing drawer for hardware installation

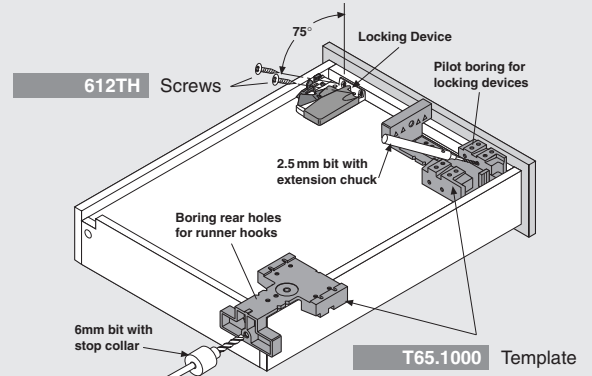

See page 32 for Template and Drill bit information

Rear view of drawer notch and bore details

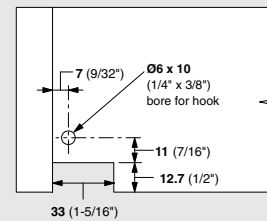

Drawer size and position in opening

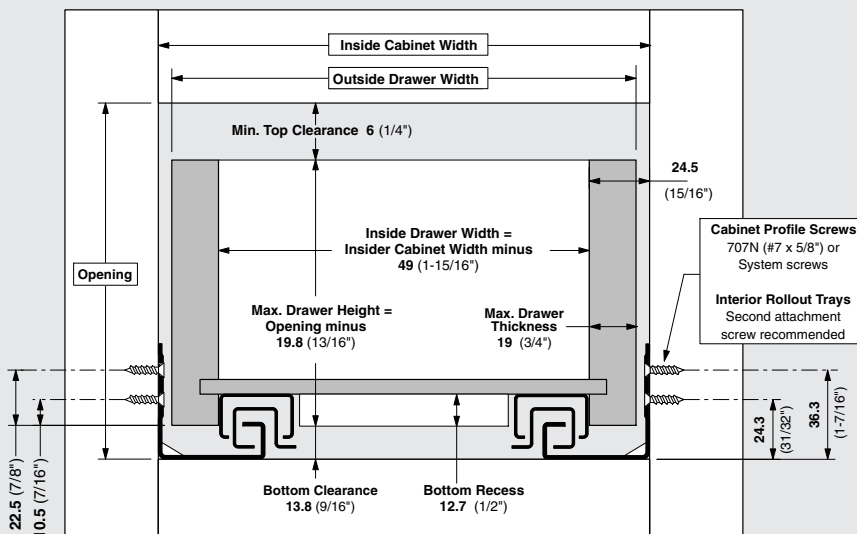

IMPORTANT: Because material thickness can vary, inside drawer width must equal inside cabinet width minus 49 (1-15/16") for drawer to align and run properly.

Calculating outside drawer width

For drawer thickness	19 (3/4")	17.5 (11/16")	16 (5/8")
Deduct from inside cabinet width	11 (7/16")	14 (9/16")	17 (21/32")

Rear mount bracket

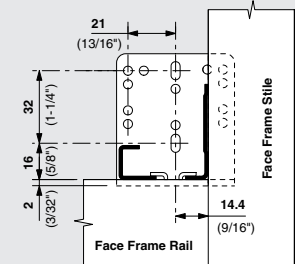

Bottom mount installation

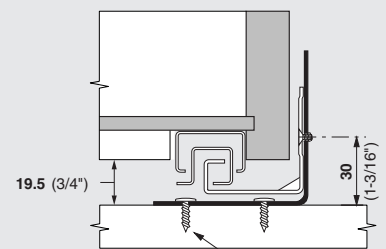

- 612TH Screws
- 295.4000 Universal Bracket kit
- Includes (4) brackets
 - Includes (8) M4 screws

TANDEM plus 562F concealed drawer runners



Full extension runner system

- Zinc coated steel profiles.
- Concealed roller carriage mechanism with permanently lubricated, synthetic rollers.
- BLUMATIC spring loaded self-closing action.
- Locking devices provide automatic latching, easy release for drawer removal and tool free height adjustment.
- Force guided right side and +/- 1/16" tolerance compensating left side.
- **34 kg (75 lb.)** Dynamic, and **45 kg (100 lb.)** Static weight capacities.

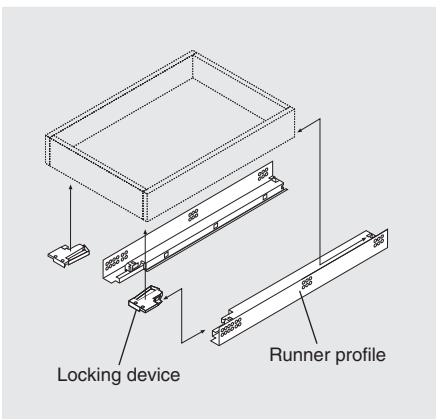

Overlay applications

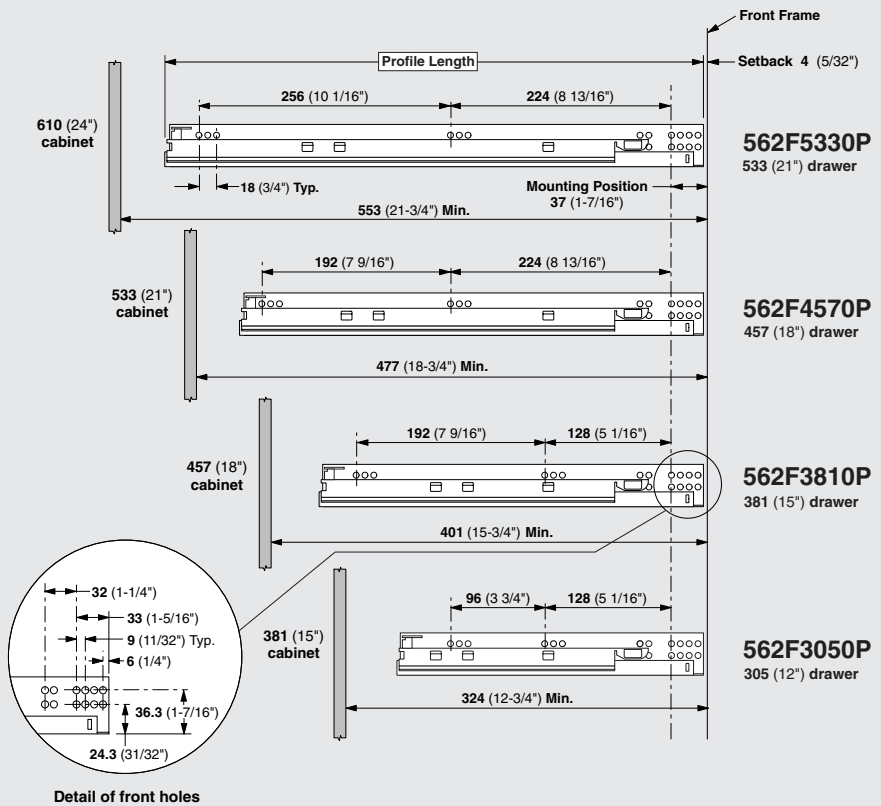

Inset applications

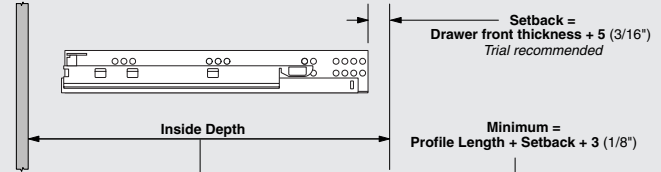

Runner Part No.	Cabinet Depth	Minimum Inside Depth	Drawer Length	Drawer Thk.	Extension Loss	Profile Length
562F5330P	610 (24")	553 (21-3/4")	533 (21")	19 (3/4") max.	0	546 (21-1/2")
562F4570P	533 (21")	477 (18-3/4")	457 (18")		0	470 (18-1/2")
562F3810P	457 (18")	401 (15-3/4")	381 (15")		-6 (-1/4")	394 (15-1/2")
562F3050P	381 (15")	324 (12-3/4")	305 (12")		-16 (-5/8")	317 (12-1/2")

Special 7/8 extension

552F2290N	305 (12")	248 (9-3/4")	229 (9")	19 (3/4")	36.7 (1-7/16")	241 (9-1/2")
-----------	-----------	--------------	----------	-----------	----------------	--------------

See mounting specifications on pg. 31

Installation components

T51.1700.04R	Locking device (right)
T51.1700.04L	Locking device (left)
295.4000	Universal Bracket kit

612TH	#6 x 1/2" Truss head screw
707N	#7 x 5/8" Flat head screw

TANDEM plus 562F specifications

Cabinet	Panel
Extension	Full
Max. drawer thk.	19mm (3/4")
Dynamic load capacity	34 kg (75 lb.)
Static load capacity	45 kg (100 lb.)

Drawer and cabinet specifications

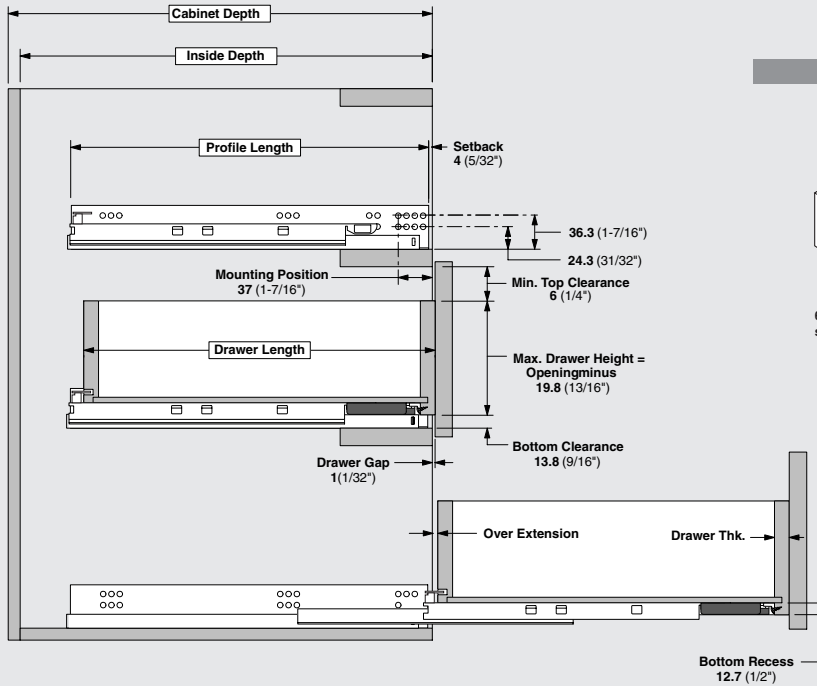

Preparing drawer for hardware installation

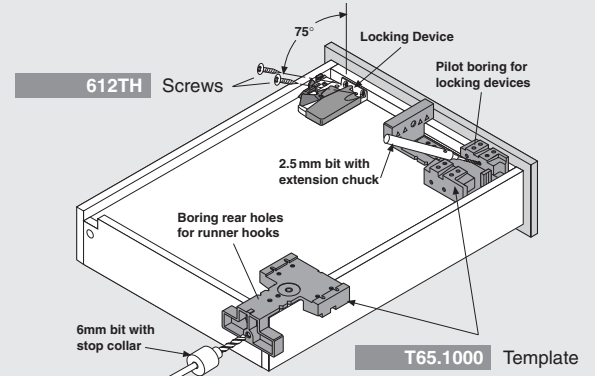

See page 32 for Template and Drill bit information

Rear view of drawer notch and bore details

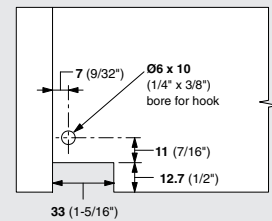

Drawer size and position in opening

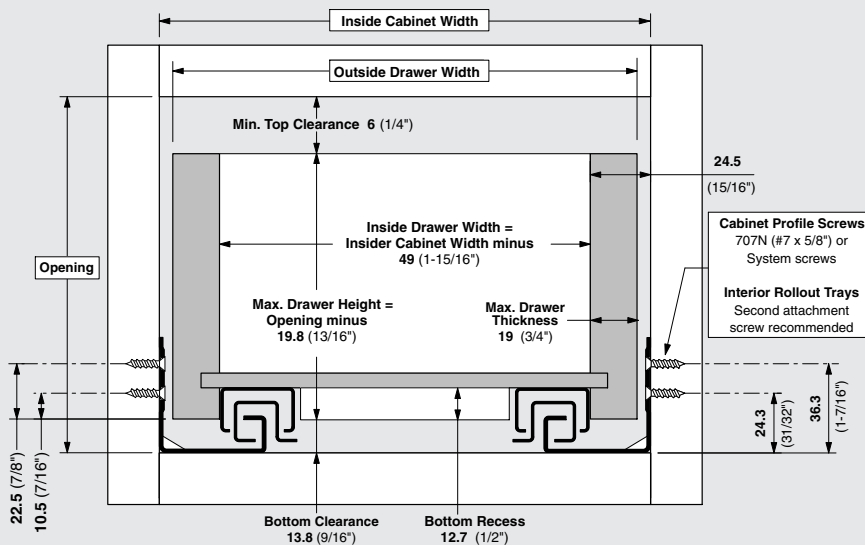

IMPORTANT: Because material thickness can vary, inside drawer width must equal inside cabinet width minus 49 (1-15/16") for drawer to align and run properly.

Calculating outside drawer width

For drawer thickness	19 (3/4")	17.5 (11/16")	16 (5/8")
Deduct from inside cabinet width	11 (7/16")	14 (9/16")	17 (21/32")

Bottom mount installation

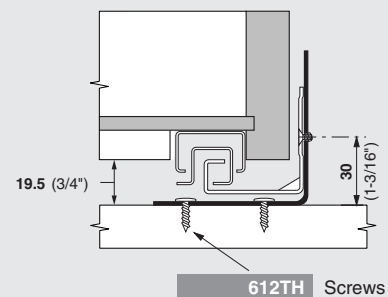

- 295.4000 Universal Bracket kit
- Includes (4) brackets
- Includes (8) M4 screws