



APPLICATIONS: Audio/Video (AV) cabinets and entertainment centers for cabinet openings up to 60" [1524mm] tall. **This product is covered by U.S. and various foreign patents issued and/or pending.**

**CBMAC -100
Media Access Center**

300 lb.* [136.4 kg.] Capacity

	Bottom	Top
Plate Dimensions	18.00" x 20.81" [457.2 x 528.6]	18.00" x 20.81" [457.2 x 528.6]
Height	2.44" [62.0]	2.56" [65.0]
Travel	20.00" [508.0]	20.00" [508.0]

Finish Black zinc (CB) finish
Load 300 lbs * [136.4 kg.] per set
Mounting Brackets
Hardware All necessary mounting hardware included. See "Package" information on back page.

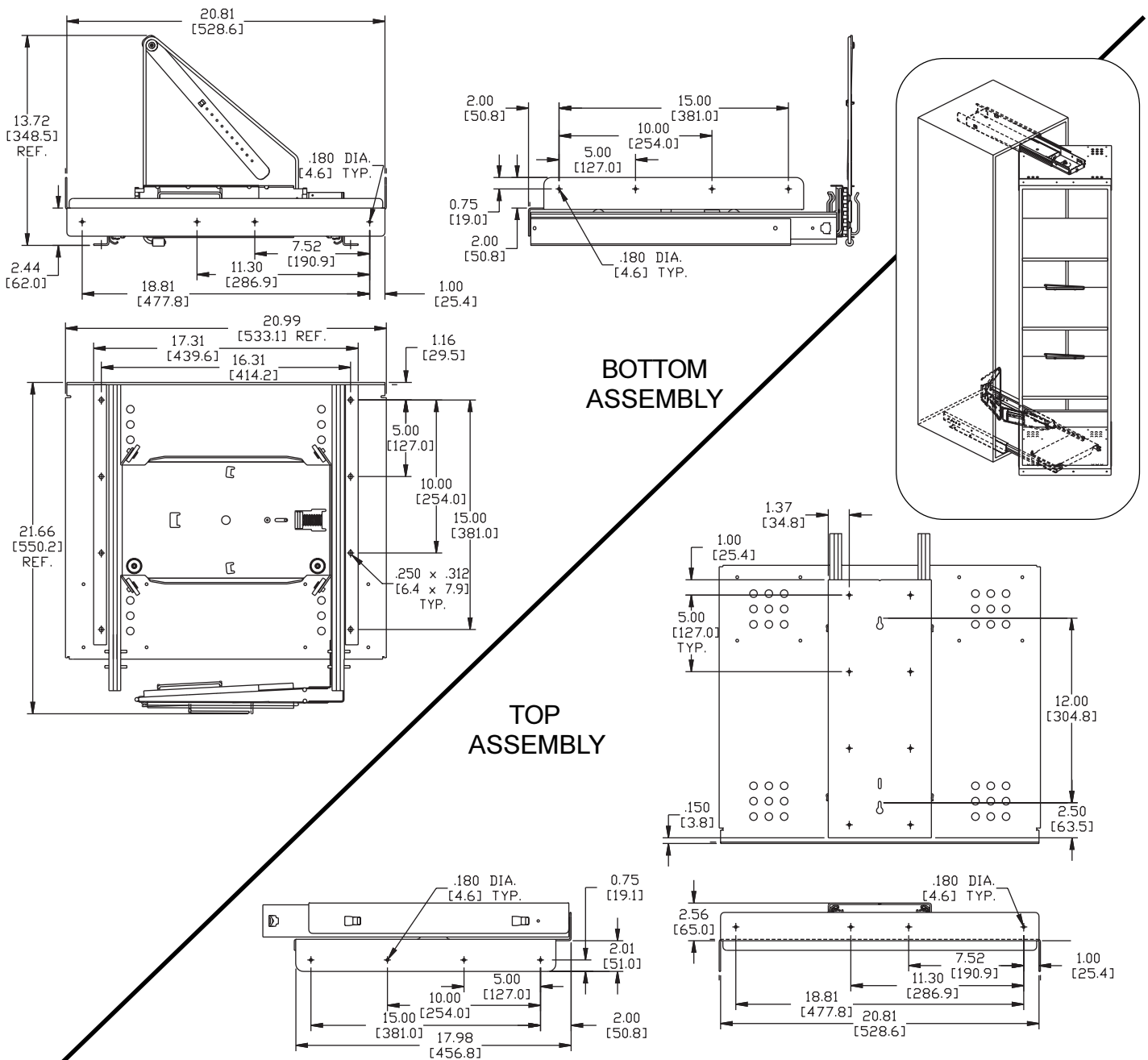

* Load rating based on 1,000 cycles

CAUTION

The floor and the ceiling of the AV-Cabinet must be constructed with materials, which have good screw holding capabilities. It is recommended that cabinet base and ceiling be a minimum of 3/4" thick furniture grade plywood.

The AV-Cabinet system is designed for a cabinet with a minimum inside width of 22.5" and 24" deep. The maximum height is 60".

The outside width of the pull-out box is 20.75". The depth is 18" and the height is 5" less than the inside height of the AV-Cabinet.

TOP ASSEMBLY

STEP 1

From inside of the cabinet, locate and mark the centerline of the ceiling from front to rear (see figure 1).

STEP 2

Locate and install two #8 X 5/8" long self tapping screws for key hole slots on the bracket (figure 1). Adjust for fascia board if required.

Do not tighten screws at this time. Leave about 1/8" of clearance between the cabinet top and the under side of the screw head.

NOTE: Set backs shown in figure 1 and 3 are for overlay applications (front face of swivel bracket flush with cabinet face). For inset applications, adjust set back to compensate for thickness of the door and fascia board (maximum allowable set back is 2.00").

STEP 3

Install the top assembly using the key hole slots. Adjust for proper set back and tighten the two screws (figure 2).

Check to ensure that the 7/8" minimum distance between the side of the top assembly bracket and the inside wall is maintained.

STEP 4

Install eight additional #8 x 5/8" long screws (figure 2).

BOTTOM ASSEMBLY

STEP 5

Locate and mark centerline of the cabinet bottom (see figure 3).

Measure and mark center line of left and right hand mounting brackets (figure 3).

Locate and mark for proper set back and additional holes. See note in step 2 for proper set back selection. Pre-drill 5/32" dia. pilot holes for #14 screws (figure 3).

STEP 6

Position bottom swivel assembly and extend slightly to access the 2 rear mounting holes. Insert and tighten a screw on each side (figure 4).

Extend slides fully and install remaining six #14 x 3/4" long screws.

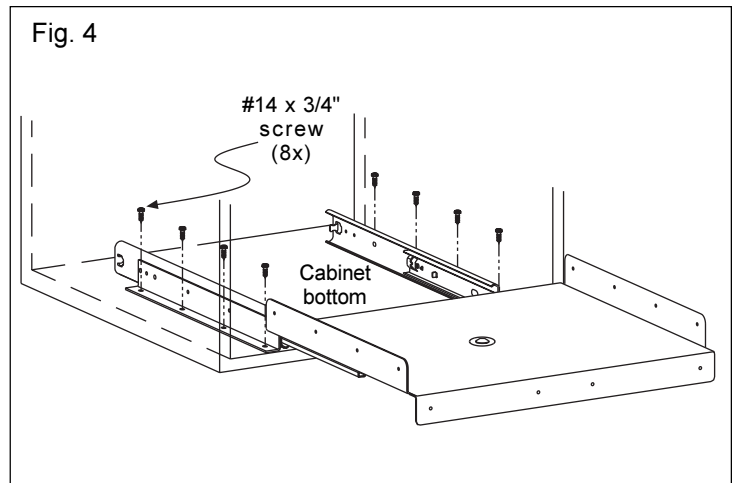
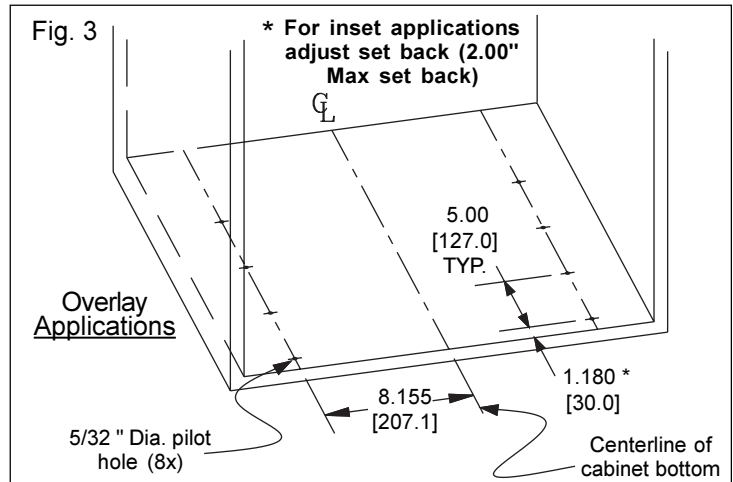
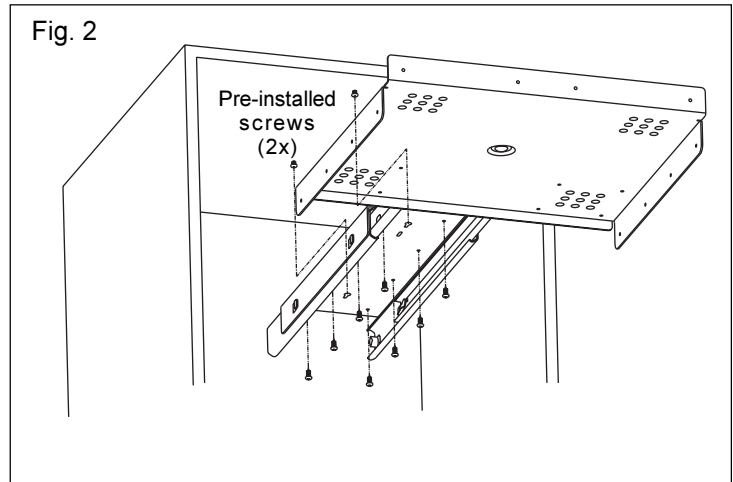
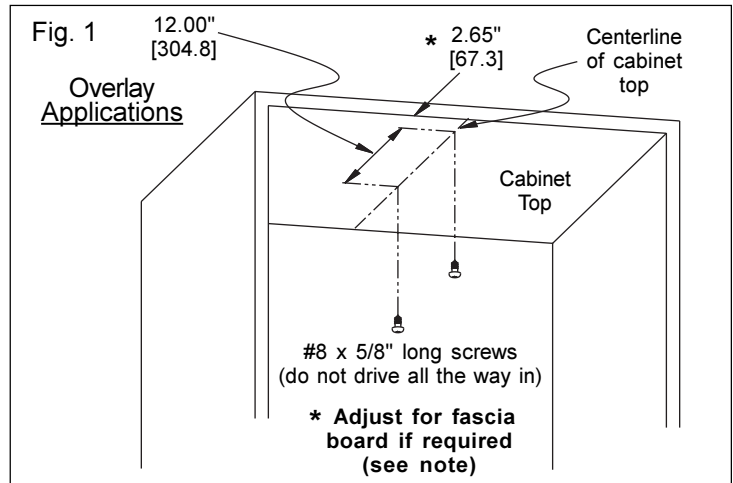

CABLE CARRIER

STEP 7

Install cable carrier rear hinge plate onto two threaded studs and secure with wing nuts (figure 5).

Extend swivel and rotate to provide clear access to two threaded studs on front of the moving member.

Assemble front hinge plate and secure with two wing nuts (figure 5).

STEP 8

Install the wire guides to the back of each shelf using the supplied #8 x 5/8" black screws (figure 6a). Wire guides can be mounted to the top or bottom of the shelf.

AV-BOX INSTALLATION

Caution: Cabinet must be counterbalanced or secured to the wall or floor before proceeding to step 9.

STEP 9

Extend bottom swivel plate straight out without rotating.

Set pull-out box on top of bottom swivel plate. Extend top swivel over the top of the pull-out box. Ensure the box is fully seated against the rear flange of top and bottom assemblies.

Secure with 16 each #8 x 5/8" self-tapping screws on top and bottom assemblies (figure 6).

WIRE MANAGEMENT

Caution: Ensure cables are supported such that they are not stressed by extension and swivel action, nor tangled in the slide mechanism.

Step 10

Fully extend the pull-out box and rotate 45° to get access to the cable carrier.

Slip the wires through the wire holder on both cable carrier arms and attach to the flexible lanyard (figure 7).

Route the wires through the wire guide attached to the shelf. Use cable ties provided to keep wires together.

OPTIONAL COOLING FAN *(not supplied by Accuride)*

Caution: Consult with a thermal management expert for proper selection and use of a cooling fan for your specific application. Accuride assumes no responsibility for damage to the electronic components as the result of improper selection or use of a cooling fan.

To expose the vent holes on the top and bottom swivel brackets, bore clearance holes on floor and ceiling of the pull-out box.

Cooling fans are typically attached to the ceiling of Pull-out box from inside (figure 8). Bottom holes can be used to exhaust heat.

Route the wire through the wire guide before plugging in. (see wiring caution on next page).

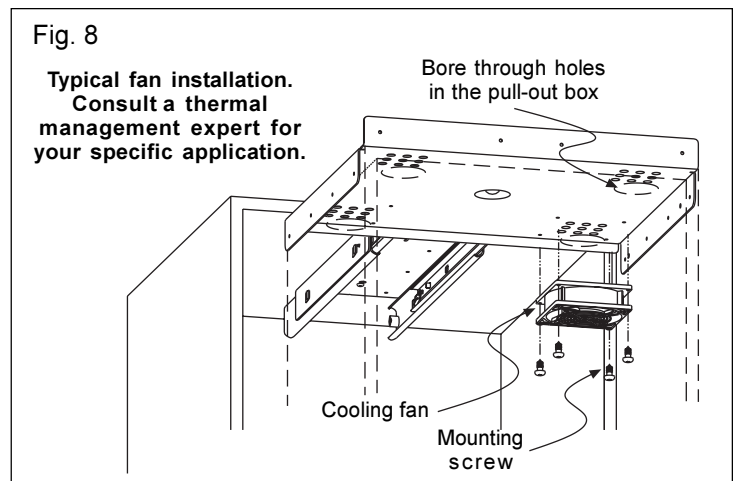
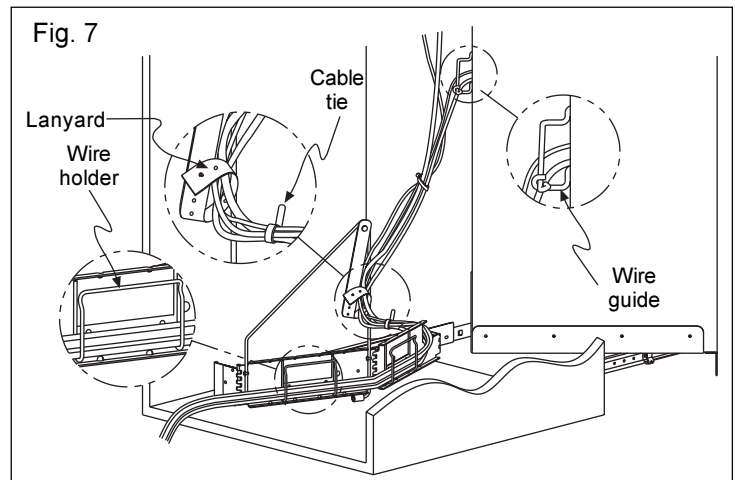
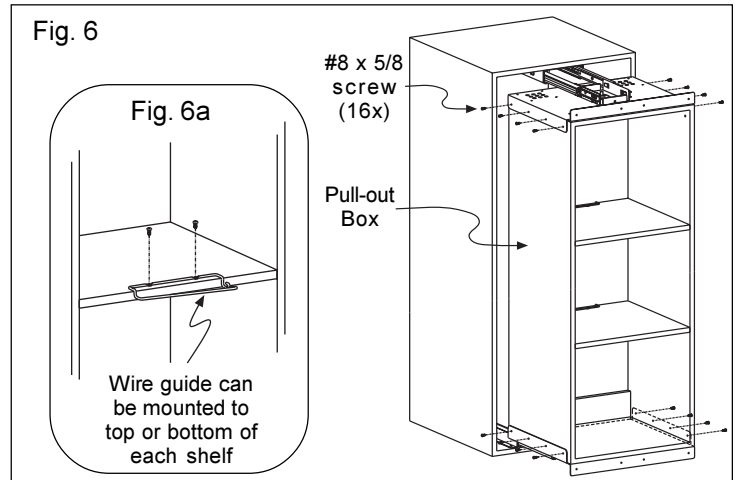
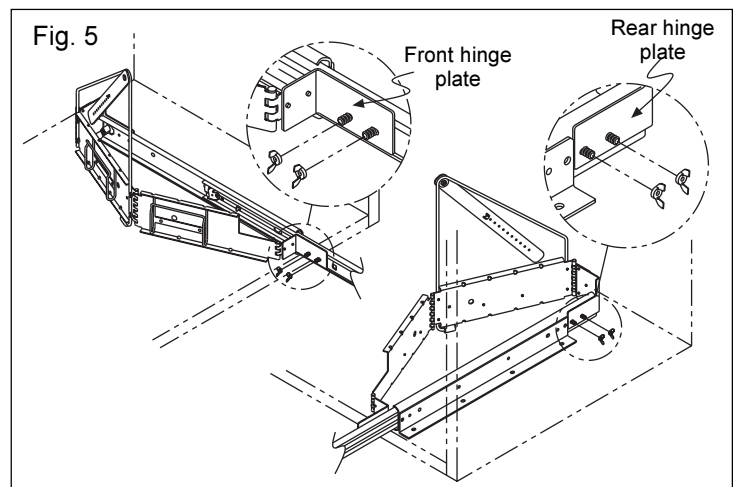

PLEASE READ THE FOLLOWING**CAUTION:**

- This product is capable of carrying the stated loads when the structure into which it is mounted is designed to safely carry such loads.
- The cabinet maker should ensure the final structure is safe and stable when carrying the maximum intended load. ANSI/BIFMA X5.6 and U.L. 1950 provide standards for static and dynamic load, stability, and endurance testing.
- These and other applicable standards can be obtained from:

American National Standards Institute
25 West 43rd street, 4th Floor
New York, NY 10036
(212) 642-4900
WWW.ANSI.ORG

Business and Institutional Furniture
Manufacturer's Association
2680 Horizon Drive, SE / Suite A-1
Grand Rapids, MI 49546-7500
(616) 285-3963
WWW.BIFMA.COM

Underwriters Lab
1285 Walt Whitman Road
Melville, NY 11747-3081
(877) 854-3577
WWW.UL.COM

In addition to the above, ensure the following:

- Ensure cables are supported such that they are not stressed by extension and swivel action, nor tangled in the slide mechanism.
- When fully loaded with the actual intended load, the entire structure must be stable when the sliding unit is fully extended.
- Before loading the unit, ensure the furniture is either counterbalanced or bolted to the floor or wall. This will ensure the furniture does not tip over when the unit is fully loaded and extended.
- Restrain components to the shelves to prevent shifting or tipping as the pull-out box slides in and out.

Complete your order for Accuride model CB MAC-100, Media Access Center, by specifying the following:

1 Each CB MAC -100

Total Units Required _____

Media Access Center Part Number _____

Packaging/Hardware Kit

The upper and lower assemblies are packaged separately.

Packaging for lower assembly includes the cable carrier, power strip and the following kits:

4180-0545-XE

2 each Wire guide
4 each #8-32 wing nut
4 each #8 x 5/8" philips pan head black screw

4180-0546-XE

8 each #14 x 3/4" slotted hex washer screw
8 each #8 x 5/8" phillips pan head black screw
1 each Load rating sticker

4180-0461-XE

6 each Cable tie

Packaging for upper assembly includes the following kit:

4180-0547-XE

18 each #8 x 5/8" phillips pan head black screw

Specifications

Slide members: Cold rolled steel
Ball retainers: Cold rolled steel
Ball bearings: Carburized steel

Note: Specifications, materials, prices, terms, and delivery are subject to change without notice.

Accuride

ACCURIDE INTERNATIONAL INC.

12311 Shoemaker Avenue
Santa Fe Springs, CA 90670

TEL (562) 903-0200

FAX (562) 903-0208

www accuride.com

Manufacturing, Engineering, and Sales

United States • Germany • Japan • Mexico • United Kingdom